



AQUA + EPS

THERMAL EPS

GYPSUM PLASTERBOARD + EPS BOARD 100
DRYWALL CONSTRUCTION

Technical Specifications

Dimensional tolerances	Type	Aqua	
Thickness: ±0,5 mm		H1	EN 520
Width: +0/-4 mm	Reaction to fire gypsum plasterboard	A2-s1,d0	EN 520
Length: +0/-5 mm	Reaction to fire EPS	EUROCLASS E	
	Thermal conductivity gypsum	$W/(m \cdot ^\circ C)$ 0.25	EN ISO 10456
	Thermal conductivity EPS	$W/(m \cdot ^\circ C)$ 0.036	EN 12667
	Densidade placa gesso laminado	kg/m^3 ≥ 660	
	Densidade EPS	kg/m^3 ≥ 20	

Application

Wall linings

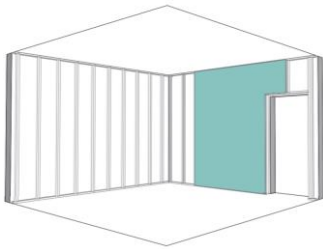

Partitions

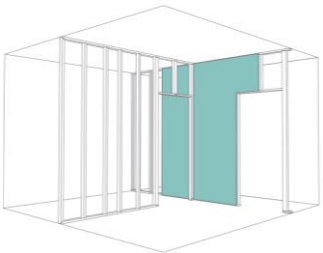

Dimensões			
Thickness:	mm	12.5+20 12.5+30 12.5+40 12.5+50 15+20 15+30 15+40 15+50	
Width:	mm	1200	
Length:	mm	2500	

Approximate weight

12.5 mm + 20/30/40/50 mm	kg/m^2	8.80 + 0.4/0.6/0.8/1.0
15 mm + 20/30/40/50 mm	kg/m^2	11.28 + 0.4/0.6/0.8/1.0

Breaking loads		EN 520	
Board Thickness		12.5	15
Longitudinal	N	≥550	≥650
Transversal	N	≥210	≥250

Edge type

Tapered Edge - TE

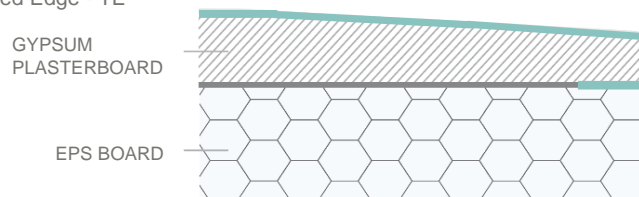

This board has a water-repellent treatment, but is not recommended for use in direct contact with water, nor in environments with permanent high humidity. It can be covered with ceramic or similar material.

Size (mm)

